

## CAMSHAFT POSITION SENSOR REPLACEMENT (WITH RPO CODES LY2/LC9/LY5/LMG)

### REMOVAL PROCEDURE

**IMPORTANT:** Clean the area around the camshaft position (CMP) sensor before removal in order to prevent debris from entering the engine.

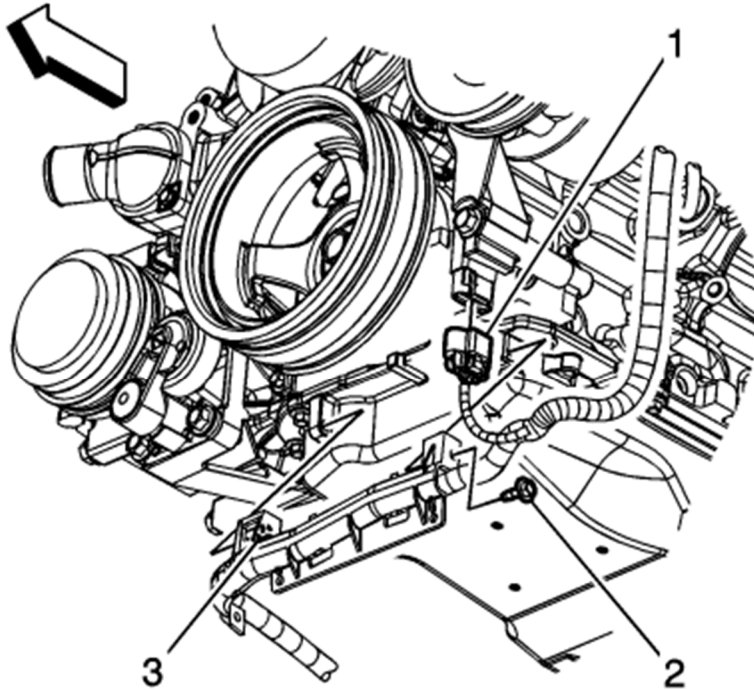

1. Raise and support the vehicle. Refer to Vehicle Lifting.
2. Disconnect the engine wiring harness electrical connector (1) from the CMP sensor wire harness.

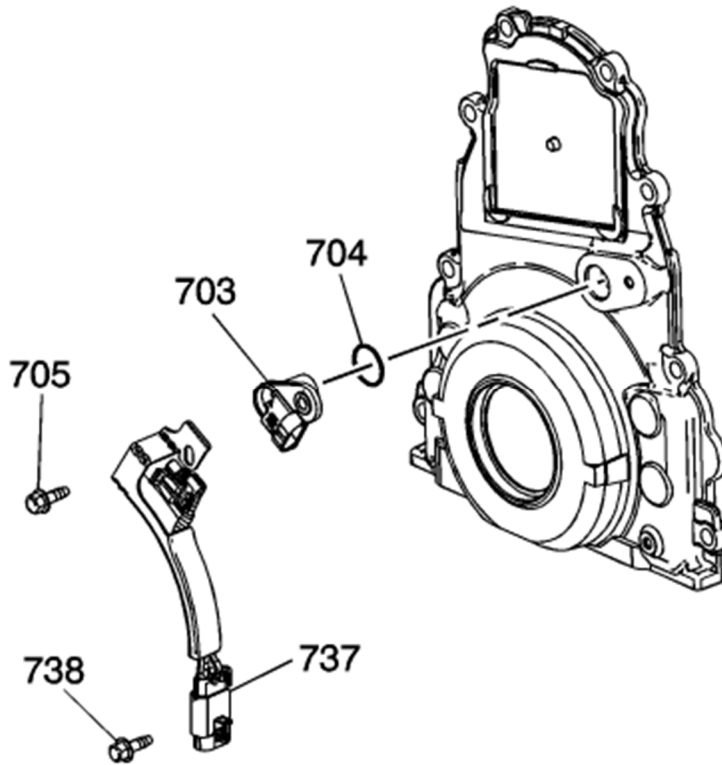

3. Remove the CMP sensor wire harness bolts (705, and 738).
4. Remove the CMP sensor wire harness (737).
5. Remove the CMP sensor (703) and O-ring seal (704).

#### **INSTALLATION PROCEDURE**

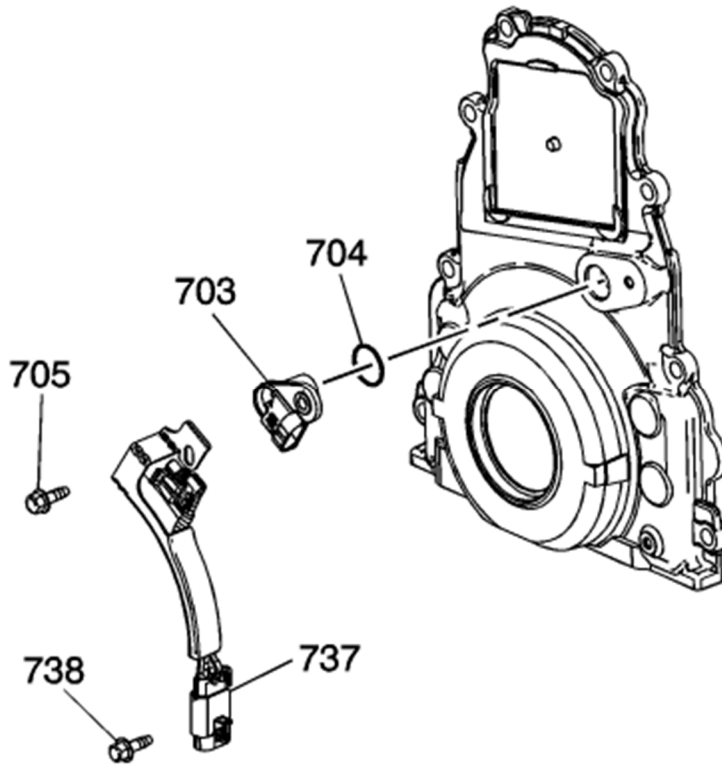

1. Inspect the CMP O-ring seal for cuts or damage. If the seal is not cut or damaged, it may be used again.
2. Lubricate the O-ring seal with clean engine oil.
3. Install the O-ring seal (704) onto the sensor.
4. Install the CMP sensor (703) to the front cover.
5. Install the CMP sensor wire harness (737).
6. **NOTE:** Refer to Fastener notice.

Install the CMP sensor wire harness bolts (705, and 738).

Tighten the bolts to **12 N.m (106 lb in)** .

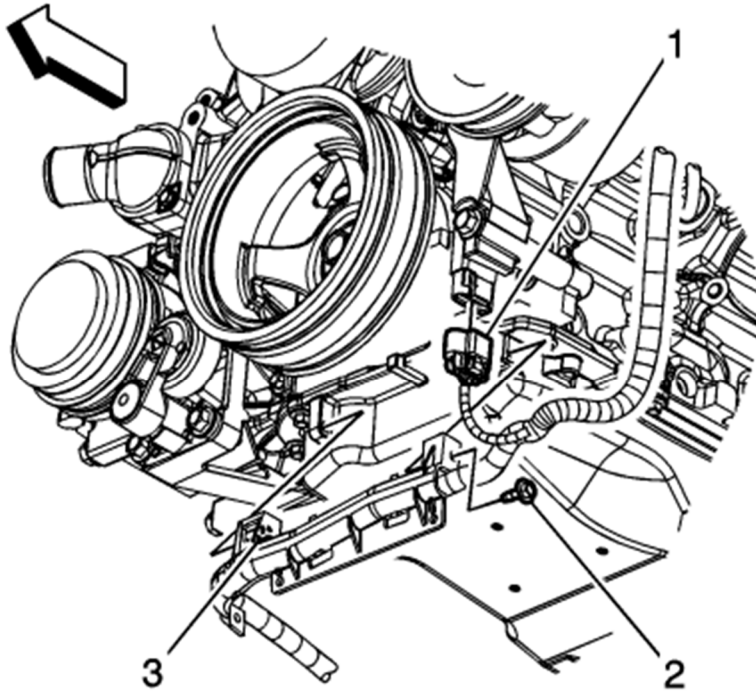

7. Connect the engine wiring harness electrical connector (1) to the CMP sensor wire harness.
8. Lower the vehicle.