

Engine Oil Pressure Sensor and/or Switch Replacement

Removal Procedure

Tools Required

[J 41712](#) Oil Pressure Switch Socket.

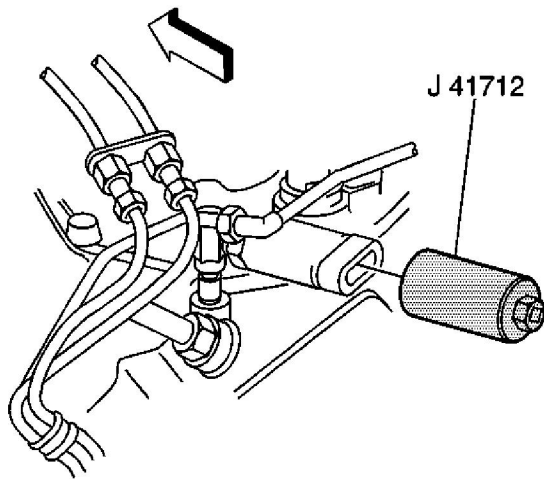

1. Disconnect the electrical connector.
2. Hold the engine oil pressure sensor fitting with a wrench.

Important: Note the alignment of the oil pressure sensor fitting prior to removal.

3. Remove the engine oil pressure sensor using [J 41712](#) .

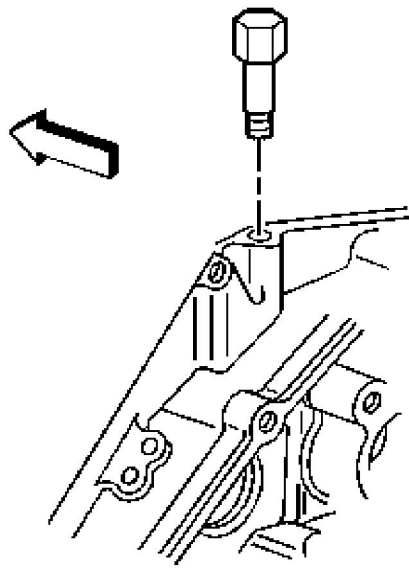

4. Remove the engine oil pressure sensor fitting, if necessary.

Installation Procedure

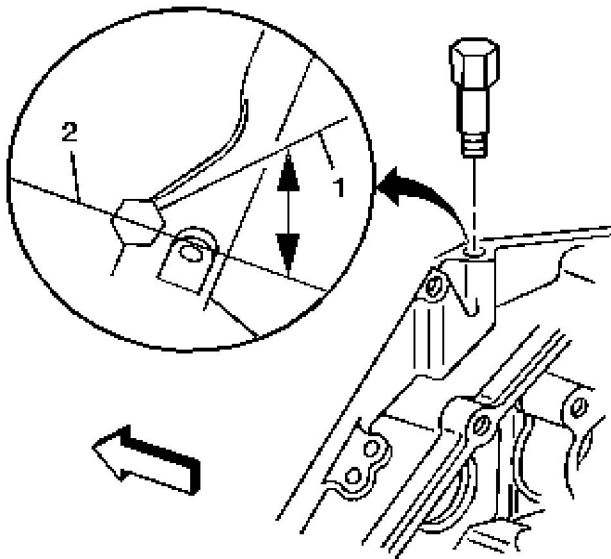

Notice: Use the correct fastener in the correct location. Replacement fasteners must be the correct part number for that application. Fasteners requiring replacement or fasteners requiring the use of thread locking compound or sealant are identified in the service procedure. Do not use paints, lubricants, or corrosion inhibitors on fasteners or fastener joint surfaces unless specified. These coatings affect fastener torque and joint clamping force and may damage the fastener. Use the correct tightening sequence and specifications when installing fasteners in order to avoid damage to parts and systems.

1. Install the oil pressure sensor fitting, if removed.

Tighten

1. Tighten the engine oil pressure sensor fitting to 15 N·m (11 lb ft).

Important: Do not loosen the fitting. Do not tighten more than one turn.

2. Tighten the fitting until properly align.

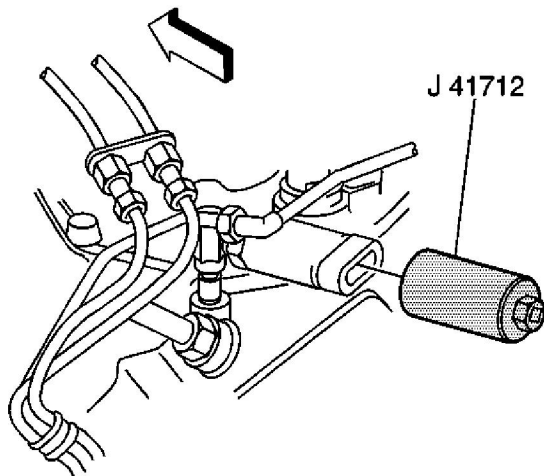

2. Install the oil pressure sensor.
3. Hold the oil pressure sensor fitting with a wrench to prevent from turning.

Tighten

Using [J 41712](#) tighten the oil pressure sensor to 30 N·m (22 lb ft).

4. Install the electrical connector.