

# Shock Absorber and Spring Assembly Replacement

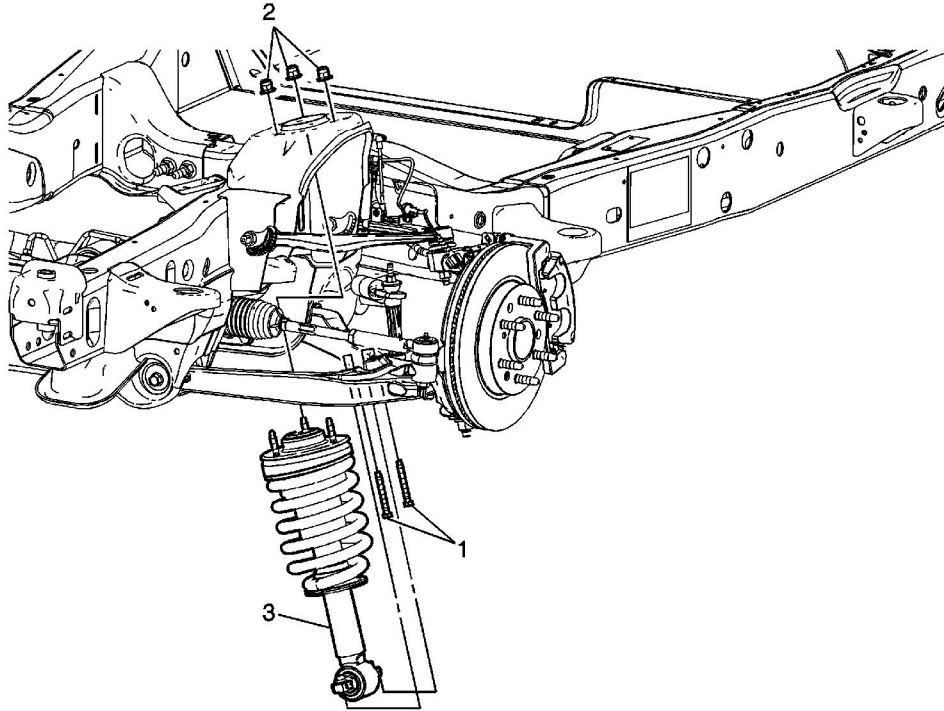

Callout	Component Name
<p><b>Preliminary Procedures</b></p> <ol style="list-style-type: none"> <li>1. Raise and support the vehicle. Refer to <a href="#">Lifting and Jacking the Vehicle</a> .</li> <li>2. Remove the front tire and wheel assembly. Refer to <a href="#">Tire and Wheel Removal and Installation</a> .</li> <li>3. Disconnect the outer tie rod from the steering knuckle. Refer to <a href="#">Steering Linkage Outer Tie Rod Replacement</a> .</li> </ol>	
<p>1</p>	<p>Shock Absorber Module Bolt (Qty: 2)</p> <p><b>Notice:</b> Do not use air powered tools in order to disassemble or assemble any vehicle component. Bolt torques are vital to diagnosis. You can detect bolt torques only when using hand tools. Improper bolt torques can contribute to vehicle repair problems.</p> <p><b>Notice:</b> Refer to <a href="#">Fastener Notice</a> in the Preface section.</p> <p><b>Procedure</b></p> <ol style="list-style-type: none"> <li>1. Support the lower control arm.</li> <li>2. Disconnect the electronic suspension control electrical connector.</li> </ol>

© 2016 General Motors Corporation. All rights reserved.

	<b>Tighten</b> 50 N·m (37 lb ft)
2	Shock Absorber Module Nut (Qty: 3) <b>Tighten</b> 50 N·m (37 lb ft)
3	Shock Absorber Module <b>Procedure</b> <ol style="list-style-type: none"><li>1. If removing the shock module to service its components, refer to <a href="#">Shock, Shock Component, and/or Spring Replacement</a> .</li><li>2. For the proper disposal procedure of the shock absorber, refer to <a href="#">Shock Absorber Disposal</a> .</li></ol>