

Shock Absorber Replacement (1500)

Removal Procedure

1. Raise and support the vehicle. Refer to [Lifting and Jacking the Vehicle](#) .
2. Support the rear axle.

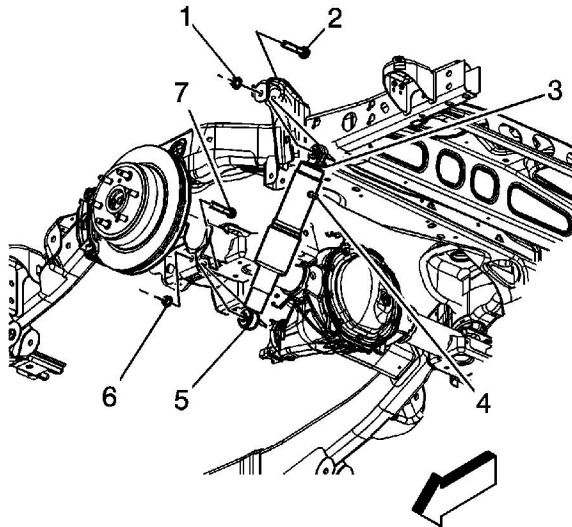

3. Disconnect the electronic suspension control connector (3), if equipped.
4. If the vehicle is equipped with air leveling, perform the following:
 - Turn the ignition On, with the engine off.
 - Install a scan tool.
 - With the scan tool, exhaust the air from the system for at least 60 seconds.

Important: There will be a minimal amount still in the air in the air lines.

5. Disconnect the air line, if equipped (4).
6. Remove the upper shock absorber nut (1) and the bolt (2).
7. Remove the lower shock absorber nut (6) and the bolt (7).
8. Remove the shock absorber (5).

Installation Procedure

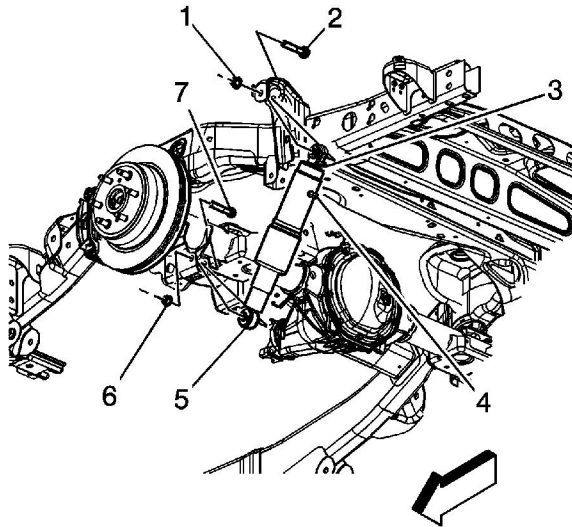

1. Install the shock absorber (5).
2. Install the upper shock absorber nut (1) and the bolt (2).

Notice: Refer to [Fastener Notice](#) in the Preface section.

3. Install the lower shock absorber nut (6) and bolt (7).

Tighten

Tighten the upper and lower shock absorber nuts (1) and (5) to 115 N·m (85 lb ft).

4. Reconnect the electronic suspension control connector, if equipped (3).
5. Reconnect the air line (4), if equipped.
6. Remove the support from the rear axle.
7. Lower the vehicle.
8. If the vehicle is equipped with air leveling, perform the following:
 - Turn the ignition ON, with the engine OFF.
 - Install a scan tool.
 - With the scan tool, operate the air compressor for 30 seconds or until rear of the vehicle begins to rise.
 - Remove the scan tool.
 - Cycle the ignition OFF, then back ON, with the engine ON to allow the air suspension system to regain the desired rear suspension position.